



THE GRANGE SCHOOL

TRANSPORT SERVICE

2025 - 2026

WELCOME

Dear Parents / Guardians,

Thank you for taking the time to look at The Grange School bus services for the 2025-2026 academic year. This is the second version of such a guide, which sets out the wide range of travel options available to the pupils at The Grange School.

We are delighted to continue our partnership with Vectare, a specialist school transport management company, to manage the school bus services. Vectare are responsible for over 2.5 million independent school journeys a year. Vectare will manage all aspects of the school's service, and any enquiries can be directed to their team at grange.vectare.co.uk.

All bookings for school bus routes are made via our online booking system, which can be viewed at grange.vectare.co.uk. This means that you no longer need to complete any paper forms. Payment for the service is made at the time of booking and your child's name will automatically be added to the register. The website also incorporates an interactive journey planner which allows you to enter your postcode and find your closest bus stop.

This guide provides an overview of the school bus service network and contains further details including fare and timetable information. All bookings for all routes can be made via the dedicated transport website.

The website allows you to book travel 24/7 from anywhere in the world, meaning that if you need to leave early for work one morning or you are running late and you would like your child to travel on a school bus as a one off, you can make a booking right up until the bus is due to depart.

Other amendments and changes can also be made via the '[my account](#)' section of the website.

If you need any further assistance, or you would like to discuss travel options from areas not currently served by our network, please contact us via the bookings website and we will be pleased to assist.

I would like to take this opportunity to wish your child a pleasant and successful academic year ahead.

Yours faithfully,

Transport Team



Scan the QR code
to make a booking!

HOW TO BOOK

ONLINE

grange.vectare.co.uk

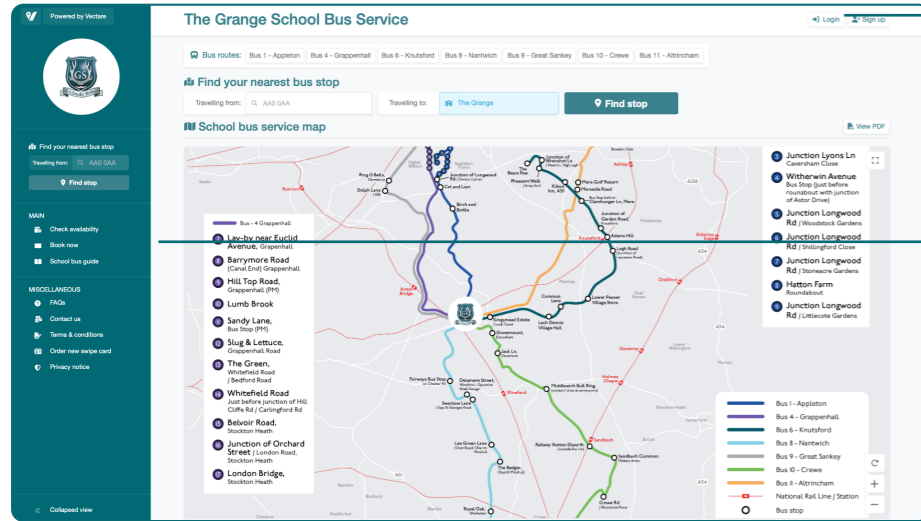

How do I sign in?

To sign up click the **“Log in”** button on the top-right of the website.

How do I make a booking?

To make a booking please click the **“Book Now”** button on the left-hand side of the website. Alternatively, if you type your postcode in under the **“Find your nearest stop”** banner on the top, you will be able to see all of your closest stops and click **“Book Now”** from here.

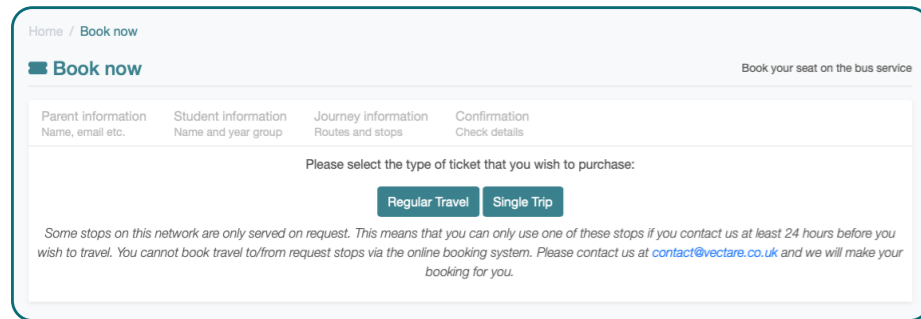

Booking / Payment

Simply fill out your information on our system once you have logged in.

Please ensure that your child arrives at the time of the booking as the bus will not wait after the departure time.

PASSENGER APP

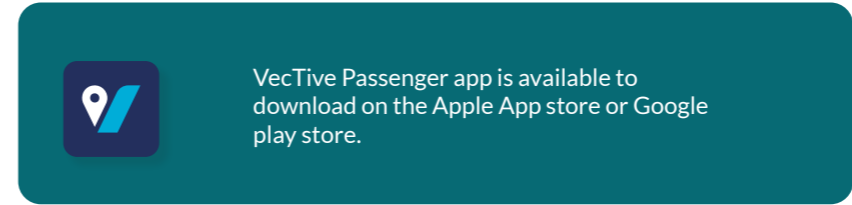

Apple (ios)



Google (android)

Mark as **Not Travelling**

To avoid unnecessary delays, don't forget to remove your child from the journey list if they are not travelling on any given day. This is easy to do on the app. Please note that if you mark a child as Not Travelling, a refund will not be given for that trip.

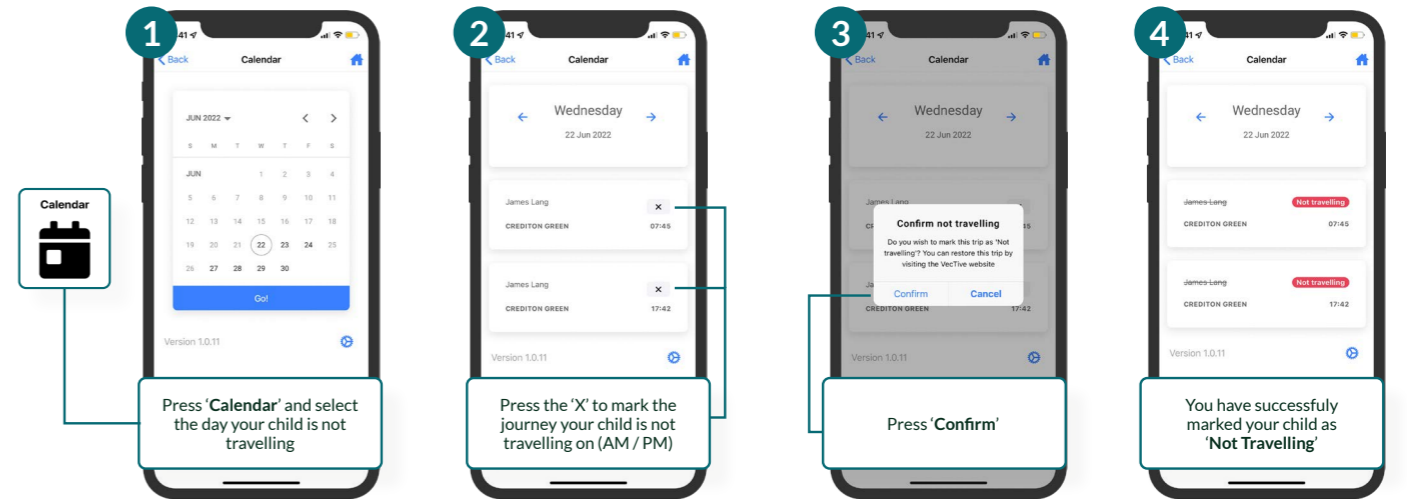

please zoom in for detail

ROUTE MAP



TIMETABLES

Bus 1 - Appleton

Stops	AM (M-F)	PM (M-F)	Price - per journey
Appleton Fairways	07:40	16:30	£6.19
Just after the junction of Lyons Lane / Park Crescent	07:42	16:32	£6.19
Junction Lyons Lane / Caversham Close	07:44	16:34	£6.19
Witherwin Avenue Bus Stop (just before roundabout with junction of Astor Drive)	07:46	16:35	£6.19
Junction Longwood Road / Woodstock Gardens	07:47	16:36	£6.19
Junction Longwood Road / Shillingford Close	07:48	16:38	£6.19
Junction Longwood Road / Stoneacre Gardens	07:50	16:42	£6.19
Hatton Farm Roundabout	07:55	16:40	£5.62
Junction Longwood Road / Littlecote Gardens	08:00	16:44	£5.62
Junction of Longwood Road / Owens Corner	08:01	16:45	£5.62
Cat and Lion	08:02	16:25	£5.62
Comberbach Memorial Hall	08:12	16:17	£5.62
The Grange School	08:25	16:05	-

Bus 2 - Congleton

Stops	AM (M-F)	PM (M-F)	Price - per journey
Holmes Chapel Road/Box Lane Bus Stop, Congleton, CW12 4NS	07:30	17:00	£5.00
Manor Lane Bus stop, before roundabout, Holmes Chapel, CW4 8AB	07:40	16:50	£5.00
Holmes Chapel Centre, opposite Doctors, CW4 7AS	07:42	16:48	£5.00
Needham Drive A50, Cranage, CW4 8FB	07:46	16:44	£5.00
Hopley Tyres A50, Cranage, CW4 8ER	07:48	16:42	£5.00
Twemlow Lane / Goostrey Lane, CW4 8DT	07:50	16:40	£5.00
Goostrey Shops, CW4 8JP	07:55	16:35	£5.00
Primrose Chase, Goostrey, CW4 8LJ	07:56	16:34	£5.00
Trading Post, Goostrey, CW4 8LP	07:57	16:33	£5.00
New Platt Lane, Goostrey, CW4 8GN	08:00	16:30	£5.00
The Grange School	08:25	16:05	-

The Congleton route brings a private route, previously run by parents, in-house. Pupils pay for all 10 journeys per week.

Bus 3 - Frodsham

Stops	AM (M-F)	PM (M-F)	Price - per journey
Rose Cottage Vet Surgery, Sutton Weaver	07:47	16:45	£6.19
Ship Street / High Street, Frodsham (Outside Morrisons)	07:50	16:43	£6.19
Fluin Lane / Red Lane	07:52	16:40	£6.19
Outside Frodsham Methodist Church	07:55	16:38	£6.19
Lady Hayes Bus Stop	07:57	16:36	£6.19
Red Bull Pub, The Brow, Kingsley	08:00	16:33	£6.19
Fortune Palace, Kingsley	08:03	16:30	£6.19
End of School Ln - Just before junction of Norley Rd	08:05	16:28	£5.62
Outside Tigers Head Pub - Norley	08:08	16:25	£5.62
Junction Cow Ln / Moss Ln Norley	08:11	16:23	£5.62
Lay-by Hollow Oak Ln, Delamere Park	08:14	16:20	£4.57
White Barn Car Park	08:16	16:18	£3.90
200 yards from Norley Road, School	08:18	16:16	£3.90
Sandiway Church, Lay-by	08:19	16:15	£3.90
The Grange School	08:25	16:05	-

Bus 4 - Grappenhall

Stops	AM (M-F)	PM (M-F)	Price - per journey
Higher Lane / Oughtrington Lane, Lymm	07:25	16:55	£6.19
Higher Lane / Grammar School Road, Lymm	07:27	16:53	£6.19
Barrs Bank, Lymm	07:29	16:50	£6.19
Bus Stop by Station Court, Grappenhall A56 (AM)	07:33	-	£6.19
Massey Brook Lane, Lymm (PM)	-	16:49	£6.19
Junction of All Saints Road, Thelwall (PM ONLY)	-	16:47	£6.19
Lay-by near Euclid Avenue, Grappenhall	07:35	16:45	£6.19
Barrymore Road (Canal End) Grappenhall	07:36	-	£6.19
Hill Top Road, Grappenhall	07:38	16:40	£6.19
Lumb Brook	07:40	16:38	£6.19
Sandy Lane Bus Stop (PM)	-	16:37	£6.19
Slug & Lettuce, Grappenhall Road	07:41	16:27	£6.19
The Green, Whitefield Road / Bedford Road	07:42	16:30	£6.19
Whitefield Road - Just before Junction of Hill Cliffe Road / Carlingford Road	07:44	16:33	£6.19
Belvoir Road, Stockton Heath	07:45	16:35	£6.19
Junction of Orchard Street / London Road, Stockton Heath	07:46	16:28	£6.19
London Bridge, Stockton Heath	07:48	16:25	£6.19
Chetwode Arms, Lower Whitley	08:00	16:18	£6.19
The Grange School	08:25	16:05	-

1

Scan the QR code or go to grange.vectare.co.uk to locate your nearest stop and book travel.



2

Make your booking and receive instant confirmation.

3

Contact Vectare via the website if you have any questions.

Bus 5 - Kelsall & Taporley

Stops	AM (M-F)	PM (M-F)	Price - per journey
Peel Hall Lane / Peel Hall Park, Ashton Hayes	07:29	16:50	£6.50
Farmers Arms, Kelsall, Bus stop before	07:35	17:00	£5.98
Bus stop by retirement flats	07:37	16:55	£5.98
St Andrew's Church	07:43	16:42	£5.98
Junction of Taporley Road / Broomheath Lane, Tarvin	07:45	16:40	£5.98
A51, Headless Woman Pub (Bus Lay-by)	07:50	16:37	£5.84
Community Centre, Taporley	07:57	16:30	£5.84
Lower Lane, Bus stop at Triangle, Eaton	08:05	16:25	£5.84
Eaton Gardens Estate	08:06	-	£5.84
The Grange School	08:25	16:05	-

Bus 6 - Knutsford

Stops	AM (M-F)	PM (M-F)	Price - per journey
The Bears Paw	07:25	16:55	£6.14
Junction of Wrenshot Lane / West Lane, High Legh	07:30	16:50	£6.14
Pheasant Walk / Arley End	07:31	16:45	£6.14
Kilton Inn, A50	07:34	16:43	£6.14
Bus Stop before Clamhunger Lane, Mere	07:36	16:40	£6.14
Junction of Garden Road, Knutsford	07:44	16:37	£6.14
Adams Hill	07:46	16:36	£6.14
Legh Road (Junction of Parkfield Road)	07:55	16:35	£6.14
Lower Peover Village Store	08:05	16:25	£5.84
Common Lane	08:07	16:22	£5.84
Lach Dennis Village Hall	08:10	16:20	£4.60
The Grange School	08:25	16:05	-



Scan the QR code to make a booking!

Bus 8 - Nantwich

Stops	AM (M-F)	PM (M-F)	Price - per journey
Wychwood Park (Abbey Park Way) / (Junction with Edenbridge Close followed by junction with Kendal Way)	07:25	17:05	£6.50
Crewe Vagrants RFC	07:35	16:50	£6.50
Peacock Hotel, Nantwich	07:40	16:45	£6.50
Barony Road opposite Junction of Mercer Way	07:45	16:40	£6.50
Royal Oak, Worleston	07:50	16:35	£6.50
The Badger, Church Minshull	07:55	16:30	£6.50
Lee Green Lane / Over Road, Church Minshull	07:57	16:28	£6.50
Swanlow Lane - Opp St George's Road	08:02	16:23	£5.77
The Old Star Pub, Swanlow Lane	-	16:24	£5.77
Delamere Street, Winsford - Opposite Shell Garage	08:05	16:20	£5.77
Fairways Bus Stop on Chester Road	08:06	16:16	£5.77
The Grange School	08:25	16:05	-

Bus 9 - Great Sankey

Stops	AM (M-F)	PM (M-F)	Price - per journey
Westbrook (opp Asda)	07:20	17:00	£6.66
Chapelford Farm pub	07:30	16:55	£6.66
Town Hall, Warrington	07:40	16:45	£5.62
Ring O' Bells, Daresbury	07:55	16:34	£5.62
Delph Lane / A56	07:58	16:30	£5.30
The Grange School	08:25	16:05	-

Bus 10 - Crewe

Stops	AM (M-F)	PM (M-F)	Price - per journey
Oakland Avenue, Haslington (PM Only)	-	17:00	£6.81
The Foresters Arms	07:45	16:55	£6.81
Sandbach Common Military Arms	07:55	16:45	£6.81
Railway Station Elworth (outside Fox Inn)	08:00	16:40	£6.81
Middlewich Bull Ring, (collect / drop at same point)	08:10	16:30	£6.81
Jack Lane, Davenham	08:18	16:17	£3.38
Grovemount, Davenham	08:20	16:15	£3.38
Kingsmead Northwich	08:23	16:08	£3.38
The Grange School	08:25	16:05	-

Bus 11 - Altrincham

Stops	AM (M-F)	PM (M-F)	Price - per journey
Sinderland Road, Bramley Hall Farm Pub	07:25	17:05	£5.50
Altrincham Cresta Court Hotel	07:30	17:00	£5.50
St Margaret's Road - Groby Road	07:35	16:40	£5.50
Stamford Arms	07:37	16:42	£5.50
Ashley Road Bus Stop Outside Gupshup	07:43	16:45	£5.50
South Downs Road - Cricket - Hockey Club	07:45	16:50	£5.50
Park Road / Barry Rise	07:52	16:55	£5.50
Mereside Road	08:00	16:25	£5.50
The Grange School	08:25	16:05	-

For Bus 11 - Altrincham, Pupils pay for all 10 journeys per week.



Scan the QR code
to make a booking!

TERMS & CONDITIONS

1. This agreement is made between all school bus passengers, their parents and The Grange School in order to provide safe, comfortable and civilised journeys for all passengers.
2. Arrangements for pupils' journeys to and from the school are the responsibility of their parents. To assist with discharging this responsibility, The Grange School provides a school bus service.
3. Transport on the school bus service must be arranged in advance and is paid for through the online booking system. If you wish to use the school bus service on an ad hoc basis, or to vary the details of their bus travel as a one-off, you should book travel via the website prior to travel.
4. Bookings on the school bus service are non-refundable in the event of a pupil failing to travel.
5. Bookings are to be made online via grange.vectare.co.uk.
6. It will be the parents' responsibility to inform the school via the '[Contact Us](#)' form on the website if they no longer wish to use the school bus service. Half a school term's notice must be given by a parent prior to the removal of a pupil from the school Transport Service (apart from an ad-hoc journey). If an ad hoc journey is cancelled with more than 24 hours' notice the booking can be transferred to another journey. The cancellation can be made on the system but parents need to contact Vectare to apply the booking to a future date.
7. No pupil is permitted to travel on the school bus service if not pre-booked for that bus. Other arrangements for journeys to and from school must be made by them or their parents.
8. Pupils must travel to and from The Grange School in full school uniform or a full school PE kit (except on approved non-uniform days).
9. Pupils should be at the bus stop five minutes before the scheduled time of departure to ensure they don't miss the service. In the evening, parents should be at the bus stop five minutes before the scheduled time of arrival to collect a passenger.
10. Good conduct is required at all times. Bullying, shouting, use of foul language, dropping litter, eating, playing music, or any other misbehaviour is strictly forbidden.
11. Except when embarking or disembarking, all passengers must remain seated with their seatbelts fastened correctly.
12. Whilst on a school bus, all passengers must accept without question the authority of a transport company official or school member or staff who may ask them to obey any reasonable instruction such as to pick up litter, desist from certain actions or to move to a different seat.
13. Failure to comply with these conditions may result in disciplinary action, including temporary or permanent withdrawal of permission to use the school bus service.
14. The Grange School aims for 95% of journeys to operate within the transport industry window of tolerance of one minute early to five minutes late, however timings may vary due to traffic conditions or unforeseen circumstances. Drivers will not wait past the scheduled departure time.
15. Pupils must be in reception or above to travel on the school bus service.



THE GRANGE SCHOOL

Produced by Vectare for The Grange School. © Vectare 2025. Timetable, route and fare information is correct as of July 2025.

This guide is produced for information only. We cannot be held liable for any errors or omissions or for any loss or damages caused, howsoever arising and including consequential losses, as a result of the use of this guide. Please note that bus routes are subject to change.